

# U-TYPE WINGWALL WITH SIDEWALK

ISSUED: 2009

PLATE  
3.4-2

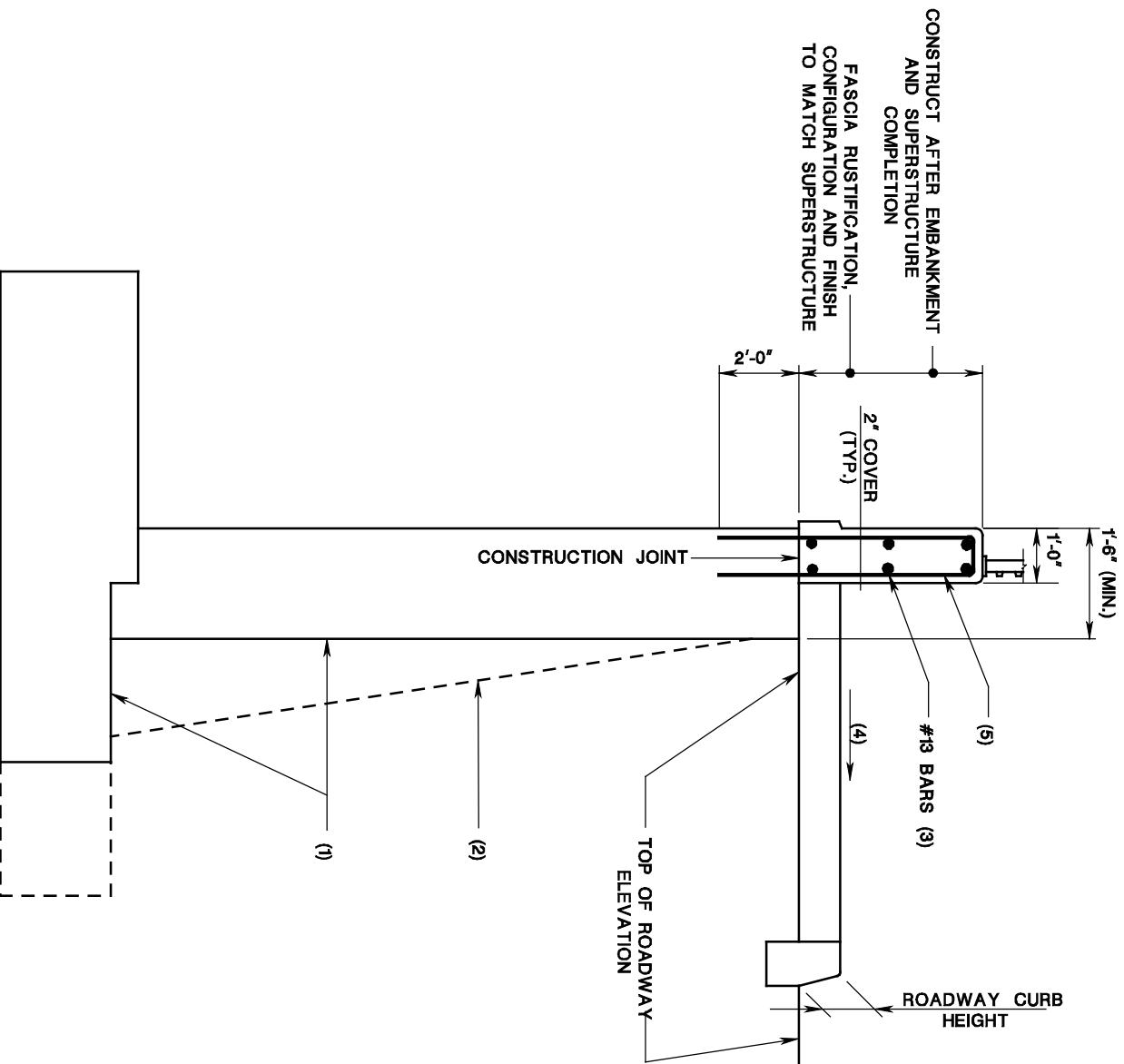

1. SEE PLATE 3.4-1 FOR TYPICAL REINFORCEMENT.
2. DESIGNER SHALL VERIFY THE NEED FOR BATTER FOR WALLS UNDER 10'-0". WALLS OVER 10'-0" SHALL HAVE A MINIMUM BATTER OF 12:1. THE HEIGHT OF THE WALL SHALL BE MEASURED FROM THE TOP OF THE HEEL OF THE FOOTING.
3. CORROSION PROTECTED REINFORCING STEEL.
4. SIDEWALK SHALL BE SLOPED 2 % FOR DRAINAGE.
5. REINFORCEMENT SHALL BE AS REQUIRED BY DESIGN.